



Bridge Route des Pêches

Porto Novo, Benin / 2022

Characteristics
Client
Scope

Single carriageway bridge with one lane in each direction and a cyclepath, including 5 composite steel-concrete girder, with a maximum length of 830 m
QGMI
Preliminary design

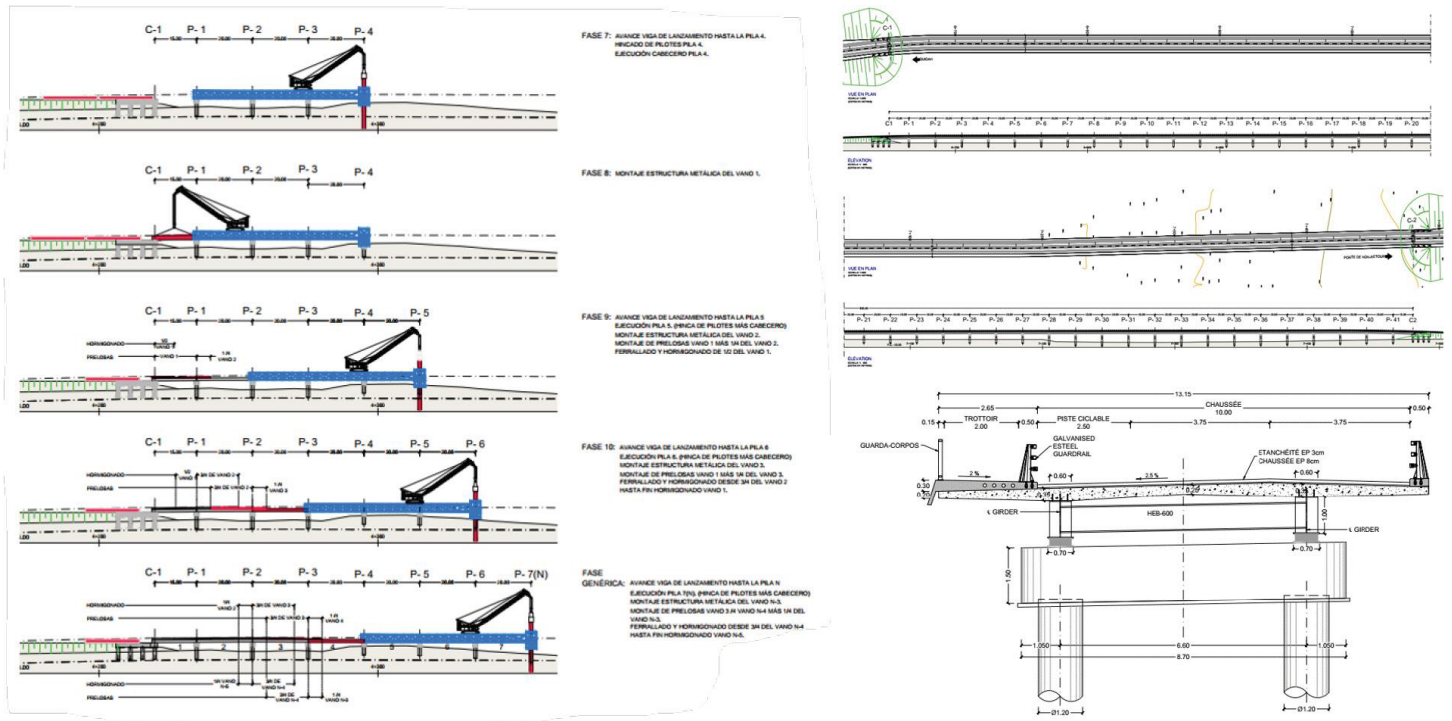

Single carriageway with one lane in each direction and a cyclepath, including 5 composite steel-concrete girder, with a maximum length of 830 m



C/ Barquillo 23, 2º | 28004 Madrid | España
T. (+34) 917 014 460 | F. (+34) 915 327 864
www.fhecor.com | fhecor@fhecor.es